



INSTALLATION

UNICEA TOMBSTONE TAILLIGHT SYSTEM 5414

PARTS INCLUDED

- 1 LED Board
- 1 Load Equalizer
- 1 Run-Turn-Brake Controller
- 2 Red LED Turn Signal Inserts
- 1 Dielectric Grease Pack
- 1 Installation Instructions

Please read and understand entire instructions before starting installation.

THANK YOU FOR CHOOSING KÜRYAKYN!

IN ORDER TO PROTECT YOU AND OTHERS FROM POSSIBLE INJURY AND/OR PROPERTY DAMAGE OR LOSS, PLEASE PAY CLOSE ATTENTION TO ALL INSTRUCTIONS, WARNINGS, CAUTIONS AND ATTENTION NOTES REGARDING THE USE AND CARE OF THIS PRODUCT.

WARNING! THIS INDICATION ALERTS YOU TO THE FACT THAT IGNORING THE CONTENTS DESCRIBED HEREIN CAN RESULT IN POTENTIAL DEATH OR SERIOUS INJURY.

ATTENTION! This indication alerts you to the fact that ignoring the contents described herein may negatively affect product performance and functionality.

CAUTION! This indication alerts you to the fact that ignoring the contents described herein can result in potential injury or material damage.

TOOLS SUGGESTED

Set of Hex Wrenches, Phillips Screwdriver, Combination Wrenches, Small Flat Screwdriver.

STRICTLY OBSERVE THE FOLLOWING GUIDELINES IN ORDER TO USE THE PRODUCT PROPERLY AND AVOID POTENTIALLY DANGEROUS ACCIDENTS.

STEP 1 Read and understand all steps in the instructions before starting the installation. Park the motorcycle on a hard, level surface and turn off the ignition.

STEP 2 Turn the ignition on and verify that the left and right turn signals are functioning properly. Turn bike off.

STEP 3 Hold the stock turn signal lens, and using a small flat screwdriver in the pry slot, carefully remove the stock lens.

STEP 4 Remove the stock bulb by gently pushing in and turning it counter-clockwise.

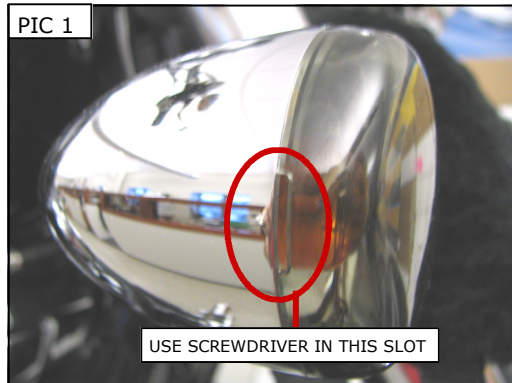

CUSTOMER SERVICE

877.370.3604 (toll free)

INSTALLATION QUESTIONS

techsupport@kuryakyn.com
or call 715.247.2983

LIMITED WARRANTY

Küryakyn warrants that any Küryakyn products sold hereunder, shall be free of defects in materials and workmanship for a period of one (1) year from the date of purchase by the consumer excepting the following provisions:

- Küryakyn shall have no obligation in the event the customer is unable to provide a receipt showing the date the customer purchased the product(s).
 - The product must be properly installed, maintained and operated under normal conditions.
 - Küryakyn makes no warranty, expressed or implied, with respect to any gold plated products.
 - Küryakyn shall not be liable for any consequential and incidental damages, including labor and paint, resulting from failure of a Küryakyn product, failure to deliver, delay in delivery, delivery in nonconforming condition, or for any breach of contract or duty between Küryakyn and a customer.
- Küryakyn products are often intended for use in specific applications. Küryakyn makes no warranty if a Küryakyn product is used in applications other than intended.
- Küryakyn electrical products are warranted for one (1) year from the date of purchase by the consumer. L.E.D.'S contained in components of Küryakyn products will be warranted for defects in materials and workmanship for 3 years from the date of purchase where as all other components shall be warranted for one(1) year. This includes, but is not limited to; control modules, wiring, chrome & other components.

• Küryakyn makes no warranty of any kind in regard to other manufacturer's products distributed by Küryakyn. Küryakyn will pass on all warranties made by the manufacturer and where possible, will expedite the claim on behalf of the customer, but ultimately, responsibility for disposition of the warranty claim lies with the manufacturer.

ABOUT OUR CATALOG

For purchasing Küryakyn® products, you can receive a complete catalog free of charge. Send the Proof-of-Purchase below with your address to: Küryakyn, P.O. Box 339, Somerset, WI 54025. Please indicate either Accessories Catalog for Harley-Davidson® or GL & Metric Cruisers.

Be sure to ask your local dealer about other Küryakyn® products, the motorcycle parts and accessories designed for riders by riders.

©2005 Küryakyn USA® All Rights reserved.



kuryakyn.com

CAUTION! LED circuit boards are polarity sensitive! Use a test light to check the polarity of the bikes wiring before connecting the LED circuit board. Küryakyn is not responsible for damage to the LED circuit board caused by reversed polarity.

STEP 5 Apply a small amount of dielectric grease to the connector from the LED turn signal; install the connector by pushing in lightly and turning clockwise. Gently press the LED turn signal lens into the housing. PIC 2

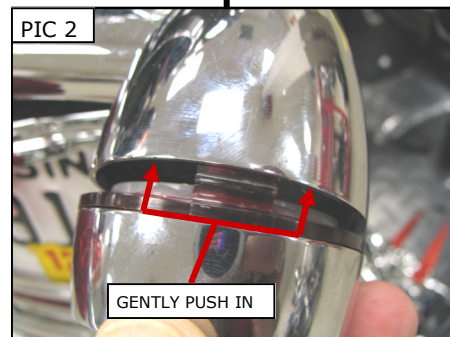

ATTENTION! Küryakyn recommends the use of dielectric grease on electrical connections.

STEP 6 Repeat STEP 2 through STEP 5 for the other side.

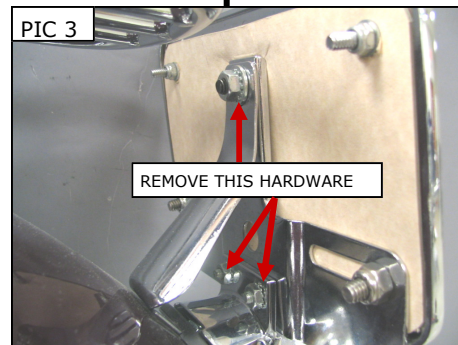

STEP 7 Turn the ignition on and verify that the right and left turn signals are functioning. They may flash fast at this time, which is alright. If the signals are not functioning, use a test light, to verify the polarity of the OEM turn signal wires. Turn the ignition off when completed.

STEP 8 Remove the license plate bracket by removing the hardware that is shown in PIC 3; set this hardware aside, it will be used again.

STEP 9 Remove the three screws that secure the taillight housing as shown in PIC 4 and remove the taillight housing. These will be reused.

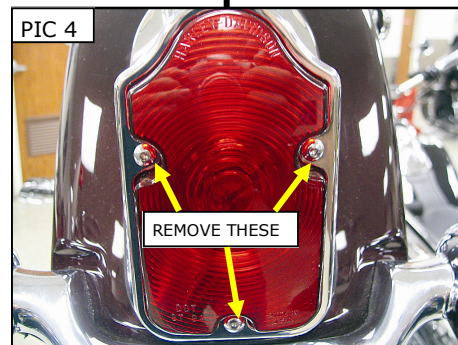

STEP 10 Remove the stock taillight bulb; apply dielectric grease to the connector from the LED board and install the connector from the LED board into the socket.

STEP 11 Place the board in the housing as shown in PIC 5 so that the holes in the mounting plate line up with the holes in the taillight housing.

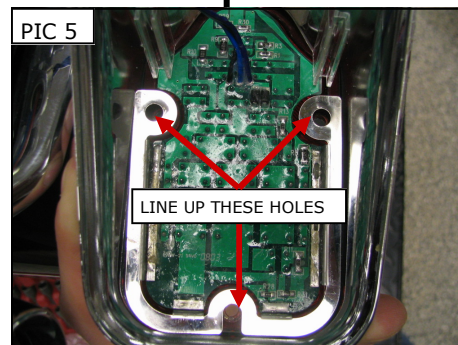

STEP 12 Reinstall the taillight housing, placing it so that the edges of the housing are on the rubber gasket; secure with the three screws that were removed in STEP 9.

STEP 13 Reinstall the license plate bracket using the hardware that was removed in STEP 8.

STEP 14 Remove the seat from the motorcycle.

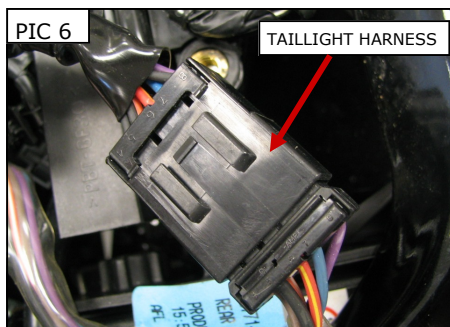

STEP 15 Locate the taillight harness and disconnect the 8-pin connectors as shown in PIC 6.

-cont.-

STEP 16 Apply a small amount of dielectric grease to the 8-pin connectors on the run-turn-brake controller.

STEP 17 Plug the 8-pin connectors of the controller into the taillight harness.

STEP 18 Plug the load equalizer into either of the white three-pin connectors from the run-turn-brake controller.

STEP 19 Place the run-turn-brake controller in a location so that the controller, load equalizer and/or the wires will not be crushed or pinched.

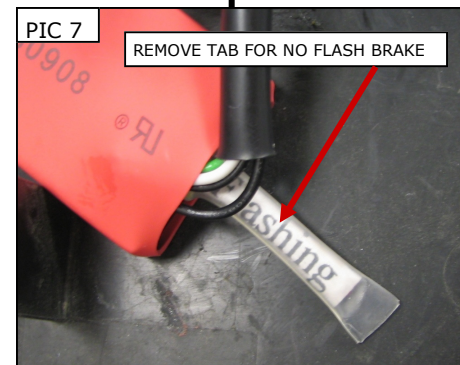

ATTENTION! Secure all wiring away from any moving parts, pinch points or extreme heat. Küryakyn **WILL NOT** warranty any electrical component that fails due to pinched, crimped, broken, abraded, melted or frayed wires.

STEP 20 Secure the load equalizer to the frame or other similar structure. Do not secure it to the run-turn-brake controller or any other heat-sensitive components.

CAUTION! Do not secure the load equalizer to the run-turn-brake control module or any other heat sensitive components! Excess heat from the load equalizer may damage components!

CAUTION! Load equalizers generate heat when in use. Avoid using turn signals for an extended period; otherwise, the load equalizer will overheat. Never operate the four-way flashers unless you first remove the load equalizer. Overheating damages the load equalizer, causing loss of turn signal operation and could create a fire hazard.

STEP 21 If you do not wish for the brake lights to flash when the brakes are applied, remove the FLASHING tab from the control module as shown in PIC 7 and replace it with the provided STOCK tab.

STEP 22 Test the system to ensure the taillight and turn signals are functioning properly. The turn signals should flash at the normal rate at this time. Reinstall the seat.

WARNING! ENSURE PROPER TURN SIGNAL AND BRAKE LIGHT OPERATION BEFORE RIDING THE MOTORCYCLE. VISIBILITY IS A MAJOR CONCERN FOR MOTORCYCLISTS. BRAKE LIGHT OR TURN SIGNAL MALFUNCTION COULD RESULT IN DEATH OR SERIOUS INJURY.

ATTENTION! It is the installer's responsibility to ensure that all of the fasteners (including pre-assembled) are tightened before operation of the motorcycle. Küryakyn will not warranty components lost due to improper installation. Periodic maintenance may be required.

Ride On!